

# RT SERIES

## RT1010NH0

SLIM INTERFACE RELAY, MULTIVOLTAGE

### TYPE

RT1010NH0 + STB10H  
Slim multivoltage relay for DIN rail  
1 CO

### MAX. CONTACT LOAD

6 A / 250 V	AC1	0,5 A / 110 V DC1
6 A / 30 V	DC1	0,2 A / 220 V DC1

### CONTACT

Material Standard AgNi

Rated current / Max. peak current	6 A / 15 A
Rated voltage / Max. switching voltage AC-1	250 V / 400 V
Rated load AC15 (250 V)	750 VA
Min. switching load	10 V / 10 mA

### COIL

Operation range	24 ... 240 V (AC/DC)
Rated power (AC/DC)	≤ 0,5 W

### INSULATION

Contact open	1 KV
Coil /Contacts	4 KV
Insulation IEC 61810-1	4 KV/3

### SPECIFICATIONS

Ambient temperature	- 40 °C ... + 80 °C
Operation / Release time	≤ 30 ms / ≤ 20 ms
Protection category	IP40
Electrical life DC / Mechanical life	1·10 <sup>5</sup> op / 10·10 <sup>6</sup> op (AC) 20·10 <sup>6</sup> op (DC)
Weight	17 g

### ACCESSORIES

Sockets	STB10H0 (24-240 VAC/VDC)
Bridge coil/contact 20 Units)	Bridge coil/contact 20 Units): BT10K

### ORDERING CODE

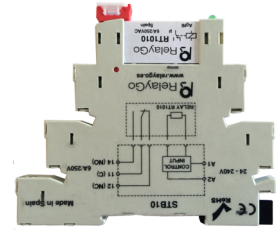
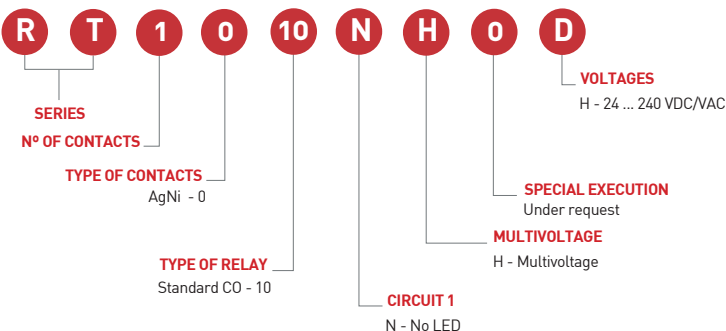

### CONNECTION DIAGRAM

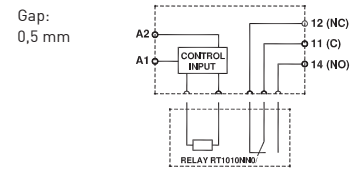

FIG. 1 ELECTRICAL LIFE AC LOAD

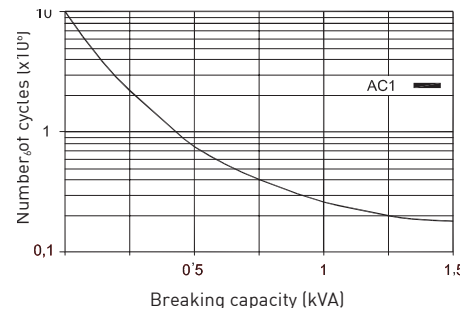
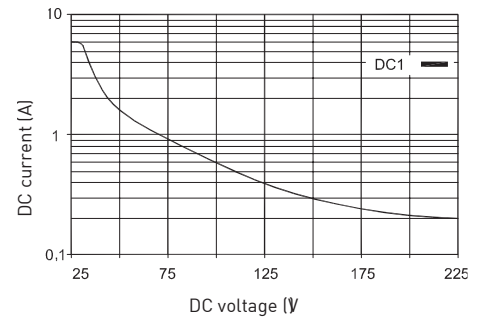
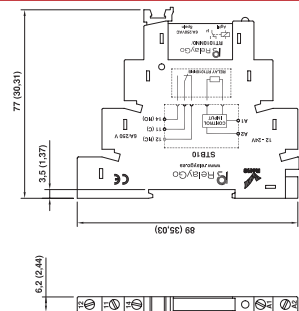

FIG. 2 MAX. DC BREAKING CAPACITY



### DIMENSIONS mm [inch]



### TECHNICAL APPROVALS



IEC 61810; EN 60947